

Dear Madam, Sir

Thank you for choosing Zoolyx - VHL Genetics. Here we explain how to take and submit samples for genetic testing.

Step 1. Sampling

A vet of your choice identifies and samples the animal using the swab included in the kit.

Unless stated otherwise, **take 1 sample per animal**. No other devices than included will be accepted.

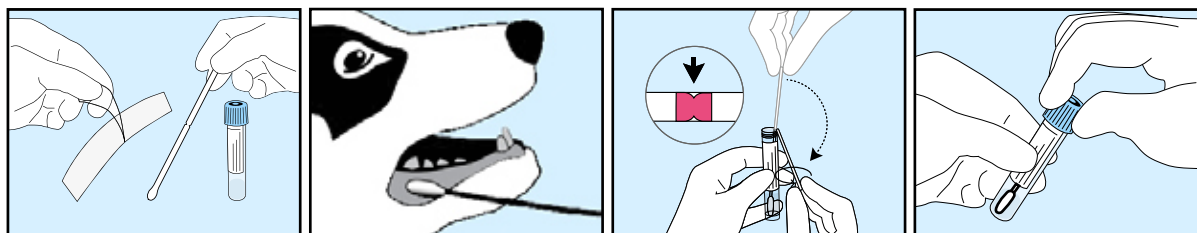

1. For best results it is advised to **prevent the animal from feeding during 30 minutes before sampling** or wash its mouth with some water.
2. Handle **one animal at a time**. Unpack the swab and tube. Don't touch the tip.
3. Collect saliva **for 30 seconds** by moving the swab and mopping saliva where it naturally pools (in the cheek pouch and under the tongue). Don't let the animal chew on the swab.
4. Uncap the tube without spilling the liquid. Insert the swab in the tube without touching the tip. Bend the **shaft to break it off** at the colored breakpoint. If needed gently rotate to complete the breakage.
5. Discard the broken handle. **Recap the tube firmly**, do not shake.
6. Attach a **chipID barcode label** on the tube (in line with the tube, not all round) and on the form. You can also write the chipID by hand on the form but watch out for errors.

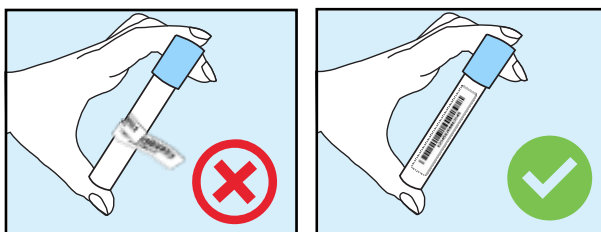

Step 2. Shipment

Put all samples in the plastic bag and seal it, insert the form in the bag's document pouch;

A. If you have chosen for shipment with retour

OR



- Put the sealed plastic bag in the retour envelope;
- Attach the retour label on the envelope. **NO STAMP REQUIRED;**
- Take note of the shipment number. You can use it to track the package via track.bpost.be;
- Submit the package at the postal office or mail box.

B. If you have NOT chosen for shipment with retour

B1. You return the samples on your own expense and in a manner of your own choice

OR

- Put the sealed plastic bag in a padded envelope;
- Return address: **Zoolyx, Groeneweg 17, B-9320 Aalst**

B2. The sample bag will be collected at your vet's clinic/practice (BELGIUM ONLY)

- Leave the sealed sample bag with your vet;
- Your vet arranges a pickup at his clinic/practice via www.zoolyx.be or 053/72.90.20.



Questions? Don't hesitate to contact us.